

COMPREHENSIVE SERVICES

We offer competitive repair and calibration services, as well as easily accessible documentation and free downloadable resources.

SELL YOUR SURPLUS

We buy new, used, decommissioned, and surplus parts from every NI series. We work out the best solution to suit your individual needs.

 Sell For Cash  Get Credit  Receive a Trade-In Deal

OBSOLETE NI HARDWARE IN STOCK & READY TO SHIP

We stock **New**, **New Surplus**, **Refurbished**, and **Reconditioned** NI Hardware.



Bridging the gap between the manufacturer and your legacy test system.

 1-800-915-6216

 www.apexwaves.com

 sales@apexwaves.com

All trademarks, brands, and brand names are the property of their respective owners.

Request a Quote

 **CLICK HERE**

SCXI-1120D

SCXI-1310/1330 CONNECTOR-AND-SHELL ASSEMBLY

This guide describes how to assemble the SCXI-1310 and SCXI-1330 connector-and-shell assemblies and how to connect the assembly to an SCXI module.

Introduction

With the SCXI connector-and-shell assembly kits, you can build your own signal cable to connect to various SCXI module inputs. The connector has eyelet-type ends for easy hook-and-solder signal connection. After you build the cable, use the shell to cover and protect the connector.

The SCXI-1310, a 96-pin connector-and-shell assembly, is for use with low-voltage SCXI modules.

The SCXI-1330, a 32-pin connector-and-shell assembly, is for use with the SCXI-1120, SCXI-1120D, or the SCXI-1121 module. The SCXI-1330 kit has 32 terminals (rows A and C, even-numbered pins only).



Note *The SCXI-1330 connector is keyed for use with the high-voltage modules.*



Warning *SCXI low-voltage modules are not intended for use with hazardous voltages (voltages exceeding 42 Vrms). National Instruments is NOT liable for any damages or injuries resulting from improper installation.*

What You Need to Get Started

You need either of the following products to build and mount your SCXI-1310/1330 connector-and-shell assembly.

- ☐ SCXI-1310 connector-and-shell assembly kit
 - Connector housing
 - 96-position connector
 - SCXI-1310/1330 Connector-and-Shell Assembly Installation Guide*
 - TBX cable adapter
- ☐ SCXI-1330 connector-and-shell assembly kit
 - Connector housing
 - 32-position connector
 - SCXI-1310/1330 Connector-and-Shell Assembly Installation Guide*
 - Two connector coding wedges
 - TBX cable adapter

The following can be used with either product:

- ☐ Your SCXI module
- ☐ 0.125 in. flathead screwdriver

Installation

Perform the following steps to build the connector-and-shell assembly and mount it to your SCXI module:

1. Refer to Figure 1 and the diagram included with your SCXI-1310 or SCXI-1330 kit to build the connector-and-shell assembly.
2. Turn off your SCXI chassis.
3. Turn off the computer that contains your plug-in board or disconnect the board from your SCXI chassis.
4. Connect the TBX cable adapter to the appropriate SCXI module and secure it by tightening both thumb screws, as shown in Figure 1.

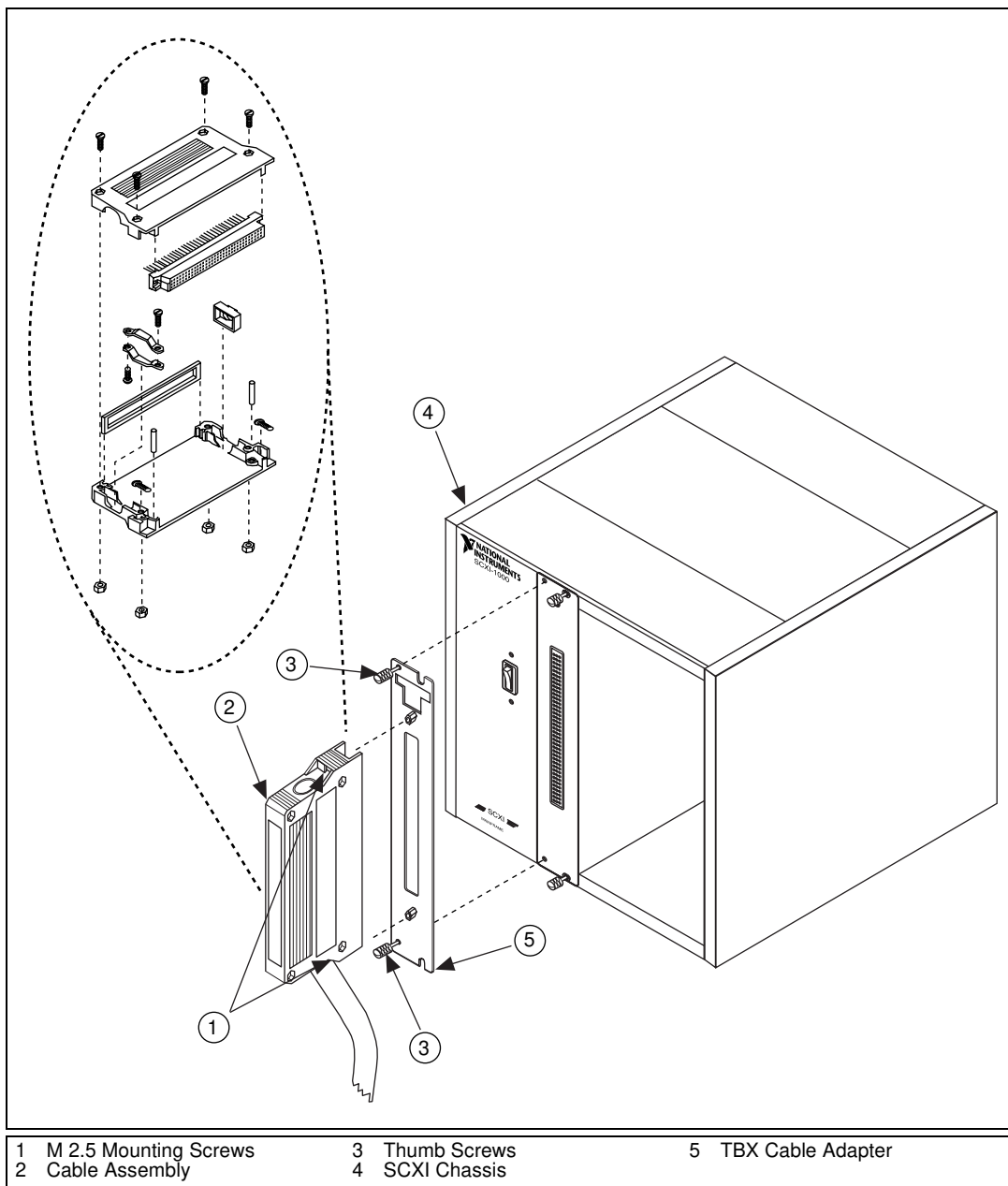

Figure 1. Connecting the Cable Assembly to the SCXI Module

5. Connect the connector-and-shell assembly to your module front connector and secure the assembly by tightening both mounting screws.